



TMS

ESTATE AGENTS



Kingfisher Meadow, Maidstone, ME16 8RB

£1,200 Per Month

- 2 BEDROOM APARTMENT
- ALLOCATED PARKING
- INTEGRATED APPLIANCES
- RIVERSIDE DEVELOPMENT
- EPC - C / Council Tax D



- 2 BATHROOMS
- CENTRAL MAIDSTONE
- BALCONY WITH RIVER VIEWS
- FURNISHED LONG TERM LET
- AVAILABLE EARLY MARCH 2026



AVAILABLE EARLY MARCH 2026~ 2 BEDROOM 1ST FLOOR
APARTMENT ~ ENSUITE ~ CENTRAL MAIDSTONE

TMS ESTATE AGENTS are pleased to offer to the market this lovely 1st floor apartment in Kingfisher Meadow. Situated just to the south of the town centre, this spacious, furnished two-bedroom apartment is available early March 2026.

The gated development with concierge and allocated parking is set on the banks of the River Medway offering picturesque walks and river views from the balcony of the apartment.

Once inside, you will find that the accommodation is light and modern with a good size lounge that opens out onto the balcony, there is a sofa, tv stand and table.

The fitted kitchen comes complete with hob, oven, extractor, fridge/freezer as well as a washer/dryer.

Both bedrooms are generous double rooms with the main bedroom enjoying an En-suite shower room, each room has beds and wardrobes, there is also a family bathroom.

The development lies just to the South of the main town centre and offers excellent access to the shops and station making it perfect for commuting. Although central, there are some lovely walks nearby particularly along the river Medway which runs alongside the development.

Council Tax Band D /EPC - C / DEPOSIT - 5 WEEKS RENT £1384.61
/HOLDING DEPOSIT - 1 WEEKS RENT £276.92

For broadband speeds and phone coverage. please check through checker.ofcom.org.uk

APPLICANTS WILL BE REQUIRED TO SHOW A MINIMUM TOTAL INCOME OF £36,000 PER ANNUM FOR SUFFICIENT AFFORDABILITY FOR THIS PROPERTY. IF A WORKING GUARANTOR IS REQUIRED THEY WILL NEED AN INCOME OF £43,200 PA TO MEET AFFORDABILITY

Call TMS ESTATE AGENTS today to book your accompanied viewing.

APARTMENT

COMMUNAL ENTRANCE HALL

ENTRANCE HALL

LOUNGE 16'6" x 12'0" (5.05 x 3.67)

KITCHEN 11'11" x 6'1" (3.64 x 1.87)

BEDROOM 1 13'7" x 10'4" (4.16 x 3.15)

ENSUITE

BEDROOM 2 9'6" x 8'11" (2.9 x 2.73)

BATHROOM

EXTERNAL

PARKING

Area Map



Floor Plans

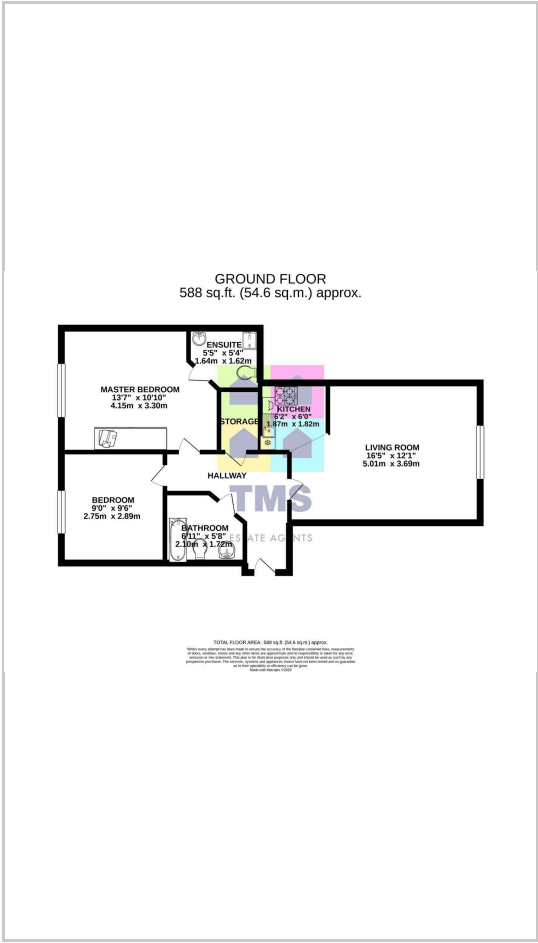

Energy Efficiency Graph

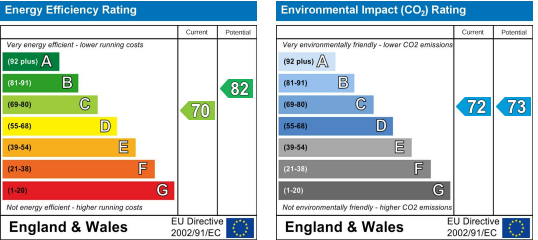

These particulars, whilst believed to be accurate are set out as a general outline only for guidance and do not constitute any part of an offer or contract. Intending purchasers should not rely on them as statements of representation of fact, but must satisfy themselves by inspection or otherwise as to their accuracy. No person in this firms employment has the authority to make or give any representation or warranty in respect of the property.